

13-0041 (HAF-500) 100 CFM AIR CONTROL UNIT

DESCRIPTION

This filter unit is designed to remove dirt, pipe scale and most liquid aerosols. Any of these, especially water, may cause severe damage to the paint finish. This unit is rated at 100 CFM.

SPECIFICATIONS

Air Inlet	1/2" NPT(F)
Air Outlet	1/2" NPT(F)
Air Capacity	100 CFM
Max. Temperature	150° F
Intermittent To	180° F
Max. Inlet Pressure	150 PSI

INSTALLATION

WARNING

Risk of personal injury.
 Risk of property damage.

Except as otherwise specified by the manufacturer, this product is specifically designed for compressed air service and use with any other fluid (liquid or gas) is a misapplication. For example, use with or injection of certain hazardous gases in the system (such as oxygen or liquid petroleum gas) could be harmful to the unit or result in a combustible condition that may cause fire or explosion. Manufacturer's warranties are void in the event of misapplication and manufacturer assumes no responsibility for any resulting loss.

WARNING

Risk of injury. Do not place unit in service without metal bowl guard installed. Plastic bowl units are sold only with metal bowl guards. To minimize the danger of flying fragments in the event of plastic bowl failure, guard must not be removed. If the unit is in service without the metal bowl guard installed, manufacturer's warranties are void and the manufacturer assumes no responsibility for any resulting loss. If unit has been in service and does not have a metal bowl guard, order one and install before placing back in service.

Figure 1

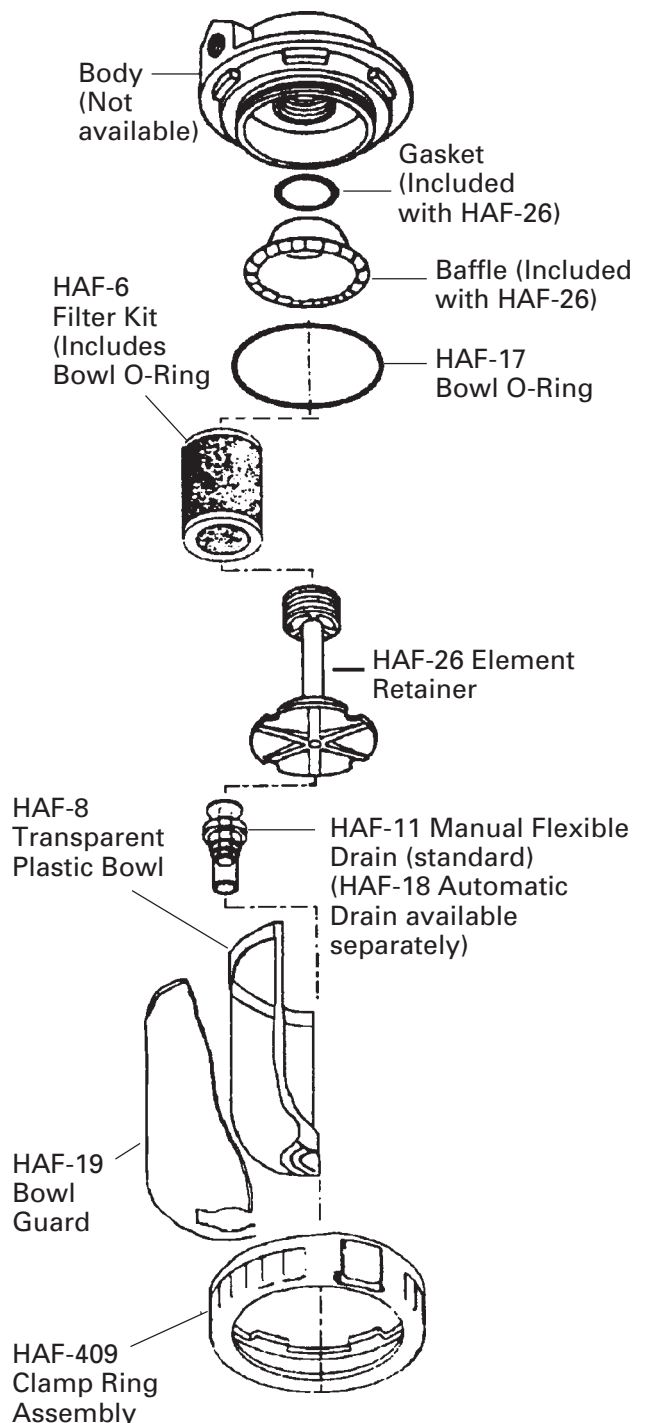

1. Be sure to read all warnings and cautions before using this equipment.
2. Install as close as possible to point where air is being used.
3. Install the unit with the air flowing through the body in the direction indicated by arrow.
4. Install the same pipe-size as the pipeline in use. Avoid using fittings, couplings, etc. that restrict airflow.
5. Maximum inlet pressure and operating temperature rating is: transparent plastic bowls, 150 psig (10.3 bar) and 150° F (65.6° C) and intermittently to 180° F (82° C).
6. Use standard and accepted methods such as industrial type pipe clamps to support vertical and horizontal pipe runs connected to this filter.
7. Install unit only in the vertical position.

MAINTENANCE

1. Each time the bowl is cleaned or the filter element replaced:
2. Depressurize unit.
3. Inspect seals and replace crazed, cracked, damaged or deteriorated seals with original manufacturer's approved seals only.
4. Replace the filter element every six (6) months, depending upon use. Filter element can be cleaned periodically by blowing off with a blow gun.
5. Drain bowl at least once per work shift.
6. Before placing the unit in service, make sure that the bowl and bowl guard are reinstalled and securely locked in place.

SERVICE NOTES

Refer to the following chart for Part No./Literature changes.

Part No. Changes			Literature Changes
Old Part No.	New Part No.	Interchangeability	
			Revised Figure 1.

WORLDWIDE SALES AND SERVICE LISTING - www.devilbiss.com

DeVILBISS AUTOMOTIVE REFINISHING

DeVilbiss has authorized distributors throughout the world. For equipment, parts and service, check the Yellow Pages under "Automobile Body Shop Equipment and Supplies".

FOR TECHNICAL ASSISTANCE, CALL TOLL FREE 1-800-445-3988 (U.S. ONLY). FOR LOCAL CALLS, SEE LISTING BELOW.

U.S. Customer Service
MAUMEE, OH 43537

Address
1724 Indian Wood Circle

Telephone Number
General Inquiry
(419) 891-8100
Toll Free Fax No. 1-800-445-6643

ACCESSORY

HAF-18 (19-0747) Automatic Drain - Remove Flex Drain from plastic bowl. Install new drain as shown in drawing. Do not assemble (or disassemble) this drain in the filter by holding the float cover. Tighten in place (or remove) using a 7/16" wrench on the thread flats. Secure nut finger tight.

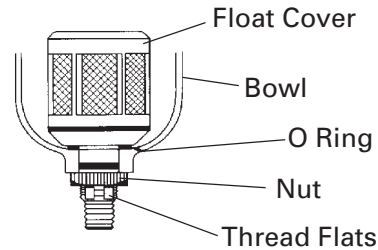

WARRANTY

This product is covered by DeVilbiss' 1 Year Limited Warranty. See SB-1-000 which is available upon request.

