

Binks MODEL 115 SPRAY GUN OPERATION & MAINTENANCE INSTRUCTIONS

The Model 115 Gun is normally used for touch-up, stenciling, and small work spraying.

CONTROLLING THE FAN SPRAY

The fan spray for an external mix nozzle set-up is easily controlled by means of the Side Port Control 55-828. Turning the Stem 55-830 to the right, or clockwise, until it is closed will give a round spray; turning it to the left, or counter-clockwise, will widen the spray into a fan shape of any width desired. The direction of the fan spray, either horizontal or vertical, is obtained by turning the air nozzle to the desired position, then tightening the retainer ring.

CONTROLLING THE FLUID

If a fluid pressure tank is used, the amount of fluid can be controlled by regulating the pressure on the tank. The amount of fluid can also be controlled by means of the Fluid Control Screw 55-875. Turning this screw to the right, or clockwise, reduces the amount of fluid; to the left, or counter-clockwise, increases the amount of fluid.

FAULTY SPRAY

A faulty spray is caused by improper cleaning or dried material around the fluid nozzle tip or in the air nozzle. Soak these parts in a solvent that will soften the dried material and remove with a brush or cloth. **NEVER USE METAL INSTRUMENTS TO CLEAN THE AIR OR FLUID NOZZLES. THESE PARTS ARE CAREFULLY MACHINED AND ANY DAMAGE TO THEM WILL CAUSE A FAULTY SPRAY.** If either the air nozzle or fluid nozzle is damaged, the part must be replaced before a perfect spray can be obtained.

TO REPLACE FLUID PACKING

Remove the Fluid Control Screw 55-875, Spring 55-881 and needle. Then remove the Fluid Packing Nut 55-898 and take out the old packing with a small stiff wire. Replace with new Packing 55-548 oiled lightly and reassemble in reverse order. Do not over tighten Fluid Packing

Nut. Doing so can prevent needle movement.

CONNECTING AIR LEAK THROUGH GUN OR AROUND VALVE STEM

Air leaking through the gun is caused by the Valve Stem Assembly 55-874 not seating properly. Air leaking around the Valve Stem may be caused by worn Packings 55-548 or damaged Valve Stem 55-874. Remove Connection 55-885, Spring 55-826, Stem 55-874, Nut 55-825 and Packing 55-548. Thoroughly clean parts and inspect for damage. Replace worn or damaged parts, put one drop of oil on Packings 55-548 and reassemble in reverse order.

TO ADJUST FLUID NEEDLE WHEN WORN

To adjust the fluid needle remove Control Screw 55-875, Spring 55-881 and Needle Assembly. With 1/4" wrench and a screwdriver, loosen the Locknuts 55-876 and 55-811, back off Locknut 55-876 one full turn and bring up Locknut 55-811 and tighten snugly. Reassemble in reverse order.

CLEANING THE GUN

When Used With Pressure Tank

Shut off the air supply to the Pressure Tank and release the pressure in the tank. Hold a piece of cloth over the gun nozzle and pull the trigger, the air will back up through the fluid nozzle and force the fluid out of the hose and into the tank. Remove paint from tank, clean tank and put enough compatible solvent into the tank to clean the hose and gun thoroughly. Spray this through the gun triggering the gun intermittently until it is clean, then blow out the fluid hose to dry it and remove all traces of materials by attaching it to the air line.

When Used With A Cup

A compatible solvent should be siphoned through gun by inserting tube from siphon cup in an open container of solvent. Trigger gun intermittently to thoroughly flush passageways and internal parts.

Binks MODEL 115 SPRAY GUN

TYPE OF FLUID TO BE SPRAYED	FLUID x AIR NOZZLES	TYPE	CFM AT			PAT. at 8"	NEEDLE
			30 PSI	50 PSI	70 PSI		
VERY THIN 14-16 SECS—NO. 2 ZAHN WASH PRIMERS DYES CLEANING FLUIDS STAINS WATER INKS	76 x 76P	PE	4.9	7.2	9.5	8"	76 SS
	77 x 77P	PE	4.2	6.8	9.3	9"	77 SS
	78 x 78S	SE	4.2	6.9		8"	78 SS
	78 x 78SD	SE	2.8	4.0		7"	78 SS
	77 x 3/4	SE	2.9	4.6		8"	77 SS
	76 x D76S	SE	2.2	3.4	4.5	6"	76 SS
THIN 16-20 SECS—NO. 2 ZAHN SEALERS PRIMERS LACQUERS	77 x 77P	PE	4.2	6.8	9.3	9"	77 SS
	78 x 78P	PE	4.8	7.0	9.4	10"	78 SS
	78 x 78S	SE	4.2	6.9		8"	78 SS
	78 x 78SD	SE	2.8	4.0		7"	78 SS
MEDIUM 19-30 SECS—NO. 2 ZAHN LACQUERS PRIMERS VARNISHES SYN. ENAMELS WALL PAINTS HOUSE PAINTS	77 x 77P	PE	4.2	6.8	9.3	9"	77 SS
	78 x 78P	PE	4.8	7.0	9.4	10"	78 SS
	78 x 78S	SE	4.2	6.8		8"	78 SS

PE—Pressure Feed—External Mix
SE—Siphon Feed—External Mix

FLUID NOZZLE ORIFICE SIZE

76	77	78
.040	.052	.070

BINKS

MANUFACTURING COMPANY

9201 West Belmont Avenue, Franklin Park, Illinois 60131

Replaces
Part Sheet
2282R-1

Part Sheet
2282R-2

Binks MODEL 115 SPRAY GUN

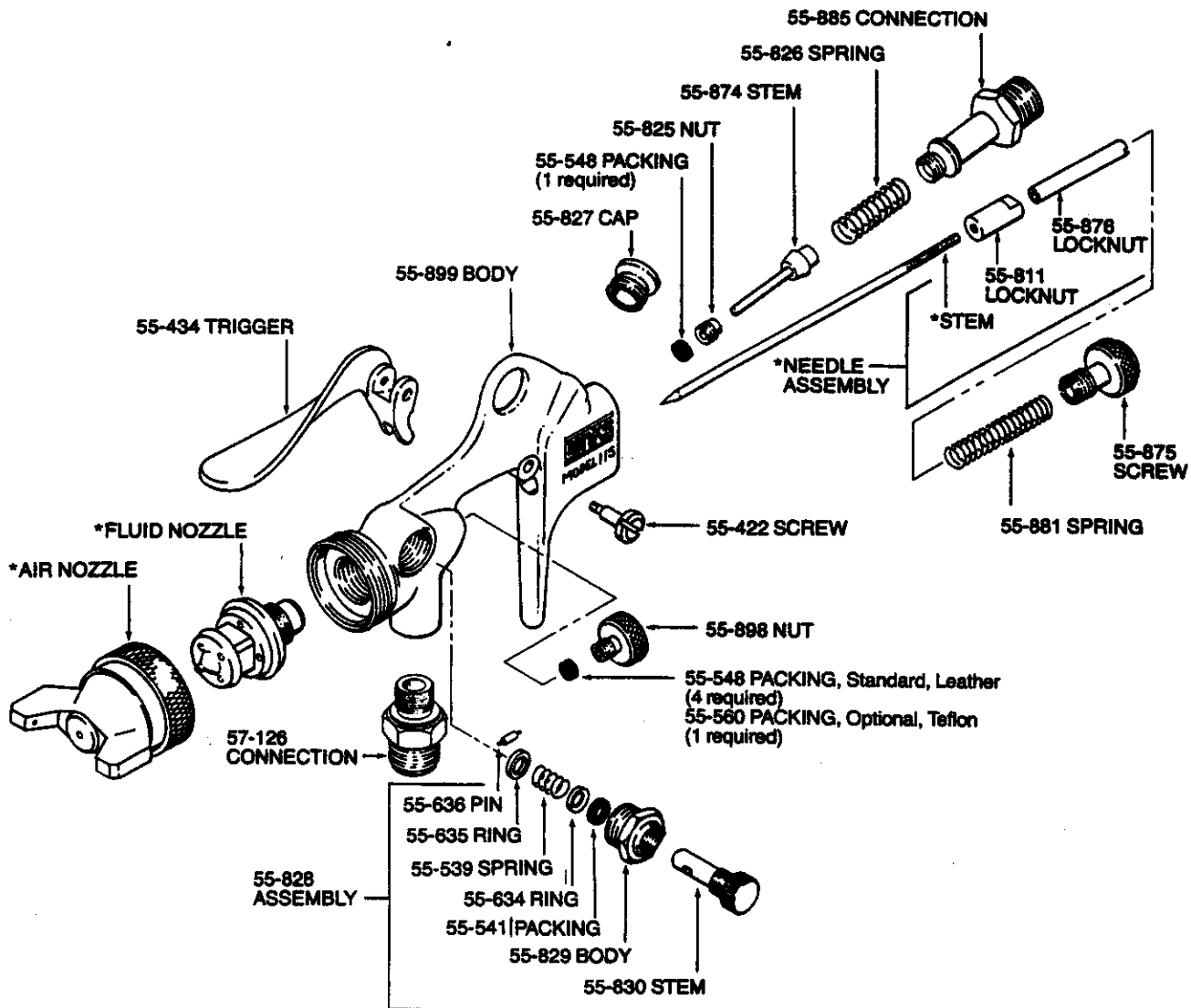

Binks Manufacturing Company, 1985. All Rights Reserved.

PARTS LIST

PART NO.	DESCRIPTION	QTY.	PART NO.	DESCRIPTION	QTY.
*	AIR NOZZLE.....	1	55-826●	SPRING.....	1
*	FLUID NOZZLE.....	1	55-827	CAP.....	1
*	NEEDLE ASSEMBLY.....	1	55-828	SIDE PORT CONTROL ASS'Y.....	1
55-422	SCREW, Trigger.....	1	55-829	BODY.....	1
55-434	TRIGGER.....	1	55-830	STEM.....	1
55-539●	SPRING.....	1	55-874●	STEM ASSEMBLY.....	1
55-541●	PACKING.....	1	55-875	SCREW.....	1
55-548●	PACKING, Standard, Leather.....	5	55-876	REAR LOCKNUT.....	1
55-560	PACKING, Optional, Teflon.....	1	55-881	SPRING.....	1
55-634	RING.....	1	55-885	AIR CONNECTION.....	1
55-635	RING.....	1	55-898	NUT.....	1
55-636	PIN.....	1	55-899	BODY.....	1
55-811	FRONT LOCKNUT.....	1	57-126	CONNECTION.....	1
55-825	VALVE NUT.....	1			

*Be sure to specify number stamped on Air Nozzle and Fluid Nozzle, or see Nozzle Selection Chart on reverse side.

Be sure to specify by number on Needle Valve Stem, and gun model when ordering, also specify Stem only or Needle Assembly.

●Also available in 6-222 Repair Kit. Please order separately.

Revision: Added optional 55-560 Teflon Packing.

Printed in USA 2/91

